



PARTS DRAWING

DOSKO

**13hp Honda GX390
Stump Grinder**

**Product Code:
DOSKO13HP**



Serial Number Range:

From:

To:

Year Of Manufacture: 2020

***Please note, when ordering online via our website if the part number is not recognised,
please Email spares@hscgroupuk.co.uk or Telephone 0115 946 1988**

KEEP THIS BOOKLET FOR FUTURE REFERENCE

Nottingham: 0115 946 1988 • London: 0208 830 3333 ✉ Nottingham: sales@hscgroupuk.co.uk • London: sean@hscgroupuk.co.uk 🌐 www.hscgroupuk.co.uk

The Hire Supply Company Terms & Conditions Apply At All Time E&OE

Parts Drawing - Rev G - 2020

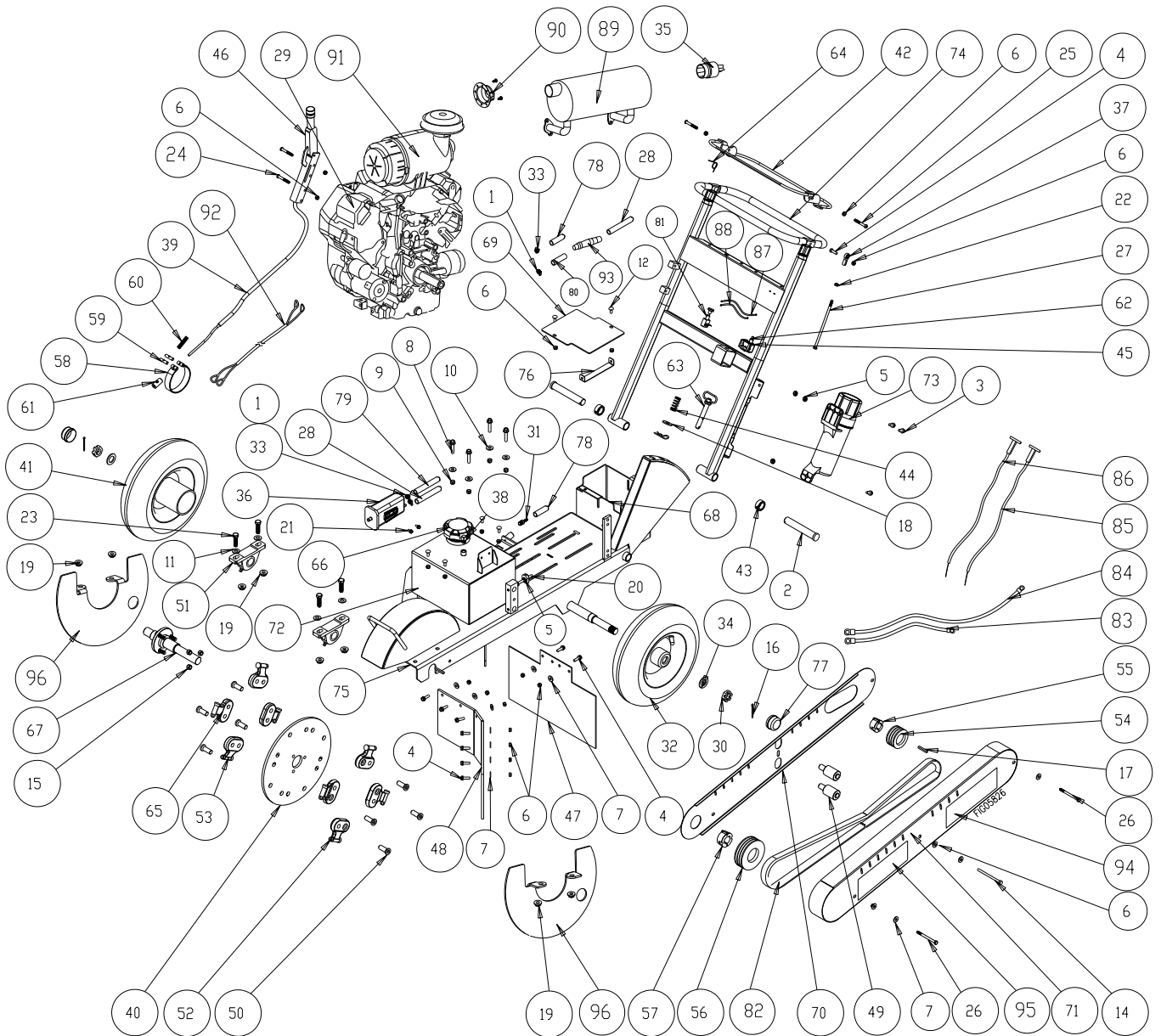

Parts List - Rev G - 2020

Parts Highlighted In Green Fit The DOSKO13HP

Item	Part #	Description	Qty	Model	Item	Part #	Description	Qty	Model	
1	30745	3/8" Hose Clamp	2	620-20HE-CE	55	783563	Bushing, 1"	1	337-13HC-CE 357-13HE-CE	
2	37878	1" x 6" Clevis Pin	2	All		784053	Bushing, 1-1/8"		620-20HE-CE 620-25KE-CE	
3	82015	5/16"-18 x 3/4" HHSF Bolt	3	All	56	783564	4.75" Sheave, 3 Groove	1	337-13HC-CE 357-13HE-CE	
4	82016	5/16"-18 x 1" HHSF Bolt	11	All		784054	4.75" Sheave, 4 Groove		620-20HE-CE 620-25KE-CE	
5	82019	5/16"-18 Ser. Flange Nut	4	All	57	783565	Bushing, 1-3/16"	1	All	
6	82020	5/16"-18 Nylon Locknut	17	337-13HC-CE	58	783567	4" Brake Band	1	All	
			23	357-13HE-CE	59	783568	Floating Pin	2	All	
			29	620-20HE-CE	60	783569	1.5" Spring	1	All	
7	82021	5/16" USS Flat Washer	12	337-13HC-CE	61	783570	Cable Clamp	1	All	
			18	357-13HE-CE 620-20HE-CE 620-25KE-CE	62	783545	Microswitch	1	All	
8	82025	3/8"-16 x 1 3/4" HHSF Bolt	4	All	63	783774	4" Hitch Pin	1	All	
9	82027	3/8"-16 Nylon Locknut	4	All	64	783924	Spring	1	All	
10	82028	3/8" USS Flat Washer	4	All	65	783554	500 Series Angled Pocket	4	337-13HC-CE 357-13HE-CE	
11	82038	1/2" SAE Flat Washer	4	All		783559	700 Series Angled Pocket		620-20HE-CE 620-25KE-CE	
12	82088	5/16"-18 x 3/4" Carr. Bolt	6	357-13HE-CE 620-20HE-CE 620-25KE-CE	66	784769	Sealed Fuel Cap	1	620-20HE-CE 620-25KE-CE	
13	782319	Purge Port Cap	1	620-25KE-CE	67	785079	Cutter Shaft	1	All	
14	82097	5/16"-18 x 4 1/2" HHCS Bolt	1	All	68	785128	Battery Box	1	357-13HE-CE 620-20HE-CE 620-25KE-CE	
15	82334	7/16"-20 Nylon Locknut	3	All					69	785130
16	82140	Cotter Pin	2	All	70	785134	Inner Belt Guard	1	All	
17	82143	1/4" X 1-3/4" Key	1	All	71	785136	Outer Belt Guard	1	All	
			2	620-25KE-CE	72	785581	Fuel Tank	1	620-20HE-CE 620-25KE-CE	
18	82205	9/16" USS Flat Washer	1	All	73	788040	Manual Tube	1	All	
19	82291	1/2"-13 Flange Locknut	8	All	74	788390	Handle	1	All	
20	82096	5/16"-18 x 3.5" Bolt	1	All	75	793483	Frame	1	337-13HC-CE 357-13HE-CE	
21	82308	M6-1 x 12MM HHCS Bolt	2	620-20HE-CE 620-25KE-CE					793484	
22	82312	5/16"-24 Hex nut	1	All	76	793512	Battery Hold-Down Strap	1	357-13HE-CE 620-20HE-CE 620-25KE-CE	
23	82035	1/2"-13 x 2.5" Bolt	4	All	77	124A	Dust Cap	2	All	
24	82322	5/16"-18 x 2.25" Bolt	2	All	78	777345	1/4" Fuel Hose	50" 27"	620-20HE-CE 620-25KE-CE	
25	82017	5/16"-18 x 1 1/2" Bolt	2	All	79	777345	1/4" Fuel Line	11"	All	
26	82353	5/16"-18 x 3.75" HHCS Bolt	2	All	80	785337	4.5mm Fuel Line	2"	620-25KE-CE	
27	82392	Linkage	1	All	81	786073	On/Off Switch w/ Black Knob	1	337-13HC-CE 357-13HE-CE	
28	785755	3/8" Fuel Line	60"	620-20HE-CE		786074				620-20HE-CE
	777345	1/4" Fuel Line	35"	620-25KE-CE		783546				620-25KE-CE
29	787618	GX390 Honda Cyclone	1	337-13HC-CE	82	783561	Belt, 3 Groove	1	337-13HC-CE 357-13HE-CE	
	601092	GX390 Estart Honda		620-20HE-CE		784056	Belt, 4 Groove		620-20HE-CE 620-25KE-CE	
	783896	GX630 Honda		620-20HE-CE		83	777108	24" Battery Cable (Black)	1	357-13HE-CE 620-20HE-CE 620-25KE-CE
	793320	CH730 Kohler		620-25KE-CE						
30	777124	1" Slotted Nut	2	All	84	793517	43" Battery Cable (Red)	1	357-13HE-CE 620-20HE-CE 620-25KE-CE	
31	777340	1/4" MPT x 1/4" Hose Barb	1	620-20HE-CE 620-25KE-CE	85	784208	Choke Cable	1	620-20HE-CE	
32	777799	Wheel	1	All	86	784207	Throttle Cable	1	620-20HE-CE	
33	777834	1/4" Hose Clamp	4	620-20HE-CE	81	786073 786074	On/Off Switch w/ Black Knob	1	337-13HC-CE 357-13HE-CE	
			5	620-25KE-CE					620-25KE-CE	
34	778844	Axle Washer	2	All					82	783561
35	781341	Spark Arrestor	1	620-20HE-CE	784056	Belt, 4 Groove	620-20HE-CE 620-25KE-CE			
36	781922	Carbon Canister	1	620-20HE-CE 620-25KE-CE	83	777108	24" Battery Cable (Black)	1	357-13HE-CE 620-20HE-CE 620-25KE-CE	
37	782399	Ball Joint Rod	1	All						
38	783212	1/4" x 1/4" Hose Barb Elbow	1	620-25HE-CE 620-25KE-CE	84	793517	43" Battery Cable (Red)	1	357-13HE-CE 620-20HE-CE 620-25KE-CE	
39	783295	Brake Cable	1	All	85	784208	Choke Cable	1	620-20HE-CE	
40	783480	Cutter Wheel, 14"	1	All	86	784207	Throttle Cable	1	620-20HE-CE	
41	783484	Wheel & Brake Drum	1	All	87	783285	8" Lead Wire, Green	1	All	
42	783493	Operator Presence Handle	1	All	88	783284	6" Lead Wire, Green	1	620-25KE-CE	
43	783538	Lock Collar	2	All	89	783395	Muffler	1	620-20HE-CE 620-25KE-CE	
44	783539	2" Spring	1	All		784059	Muffler Canister			
45	783769	Microswitch Bracket	1	All	90	785508	Exhaust Deflector w/ Screws	1	337-13HC-CE 357-13HE-CE	
46	783547	Brake Lever Assembly	1	All	91	785411	Air Cleaner for GX630	1	620-20HE-CE	
47	783550	End Flap	1	All	92	786072	Wire Harness	1	337-13HC-CE 357-13HE-CE	
48	783551	Chute Flap	1	All					783283	
49	783552	Idler Bearing	2	All	93	785769	1/4" x 3/16" Hose Mender	1	620-25KE-CE	
50	783555	Lo-Pro Pocket Bolt	8	All	94	783544	Stump Grinder Decal	1	All	
51	783556	Pillow Block Bearing	2	All	95	783543	Dosko Decal	1	All	
52	783557	500 Series Tooth	8	337-13HC-CE 357-13HE-CE	96	790895	Cutter Guard	2	All	
	792160	700 Series Tooth		620-20HE-CE 620-25KE-CE						
53	784165	500 Series Straight Pocket	4	337-13HC-CE 357-13HE-CE						
	784166	700 Series Straight Pocket		620-20HE-CE 620-25KE-CE						
54	783562	3" Sheave, 3 Groove	1	337-13HC-CE 357-13HE-CE						
	784052	3.35" Sheave, 4 Groove		620-20HE-CE 620-25KE-CE						

Complete 500 Series Tooth Set - P/N DOSKO13TSNEW



Recycling



ENVIRONMENTAL PROTECTION: Please recycle any unwanted materials as opposed to disposing them as general waste. It is recommended the original is retained and used to store the product when not in use for prolonged periods of time. If this is not applicable ensure the materials are sorted and recycled in accordance with local regulations.



SPECIFICATION CHANGE: It is our policy to continually improve products to ensure these meet the rigours of the industry we serve. Therefore, as such we reserve the right to alter specifications, data, components & parts with-out prior notice.

WARRANTY: Please refer to the manufactures terms & conditions.

IMPORTANT: No liability will be accepted for the incorrect use of this product.

KEEP THIS BOOKLET FOR FUTURE REFERENCE

📞 Nottingham: 0115 946 1988 • London: 0208 830 3333 ✉ Nottingham: sales@hscgroupuk.co.uk • London: sean@hscgroupuk.co.uk 🌐 www.hscgroupuk.co.uk

The Hire Supply Company Terms & Conditions Apply At All Time E&OE